



JHWSCOE50
1/2 Drive Open End Crowfoot
Wrench, Satin Chrome Finish,
1-9/16"



PRODUCT DETAILS

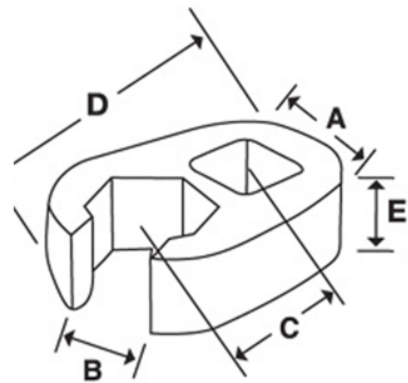

- Crowfoot wrenches are professional quality, made of high grade steel

- Featuring an open end with a continuous arc for constant contact with the fastener for greater turning power without deforming the fastener



PRODUCT ATTRIBUTES

Product: **JHWSCOE50**

| | | | | | |
|---|------------|---|------------|----------|------------|
|  | 1/2 in |  | 1-9/16 in | A | 2-31/32 in |
| C | 1-31/32 in | E | 15/32 in | F | 5/8 in |
| D | 3.25 in | A | 2-15/32 in | E | 1 in |
| B | 1-11/32 in | lb | 0.59 lb | | |