



JHW16-640

3/4" Drive Deep Impact Socket 6-Point 1-1/4", Black Industrial Finish





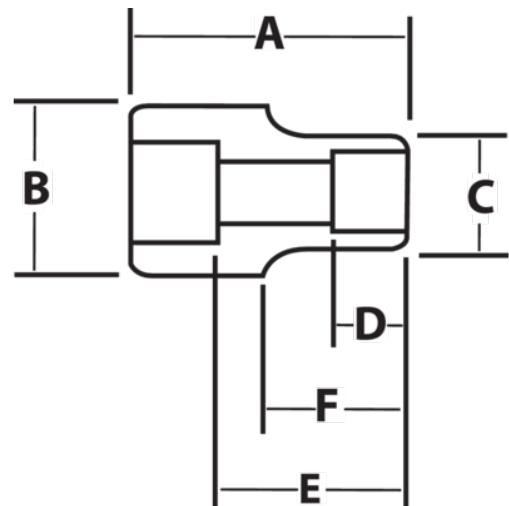

PRODUCT DETAILS

- SUPERTORQUE® lobular openings for greater turning power without deforming the fastener
- Designed for maximum engagement on 6 point fasteners
- Suitable for use with pneumatic and electric impact wrenches
- Specially heat treated for impact use to provide long life, safety, and durability



PRODUCT ATTRIBUTES

| Product |  |  | A | B | C | D | E |  | F |  |
|-----------|---|---|----------|----------|------------|--------|-----------|---|--------|---|
| JHW16-640 | 3/4 in | 1-1/4 in | 3-1/4 in | 1-3/4 in | 1-15/16 in | 7/8 in | 2-9/32 in | 1-1/4 in | 7/8 in | 1.72 lb |