



**JHW6C15T12**  
**15T Single Acting Cylinders 12"**  
**Stroke 3/8"**





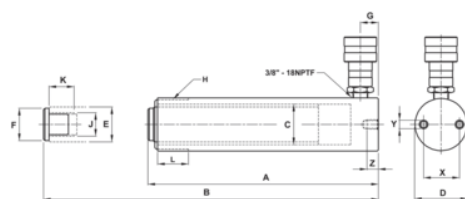

## PRODUCT DETAILS

- 39 models
- Internal plunger threads
- Snap in grooved saddles
- Rod wiper seals out dirt and contamination
- Collar fixture threads
- Two base mounting holes on most models
- Our most rugged, high torque capacity ratchet



PRODUCT ATTRIBUTES

Product: **JHW6C15T12**

	15 t		12.01 in		3.14 in
<b>PSI</b>	9550 psi		37.71 in <sup>3</sup>	<b>A</b>	16.65 in
<b>B</b>	28.66 in	<b>C</b>	2 in	<b>D</b>	2.75 in
<b>E</b>	1.63 in	<b>F</b>	1.5 in	<b>G</b>	0.98 in
<b>H</b>	2-3/4-16 in	<b>L</b>	1.18 in	<b>J</b>	1"-8UNC in
<b>K</b>	0.98 in	<b>X</b>	1.88 in	<b>Y</b>	3/8"-16UNC in
<b>Z</b>	0.51 in				