



BCF20 - BCF34
3/8 Dr Crowfoot Wrenches, Flare
Nut, 12 Point, SAE





PRODUCT DETAILS

- Crowfoot wrenches are professional quality, made of high grade steel

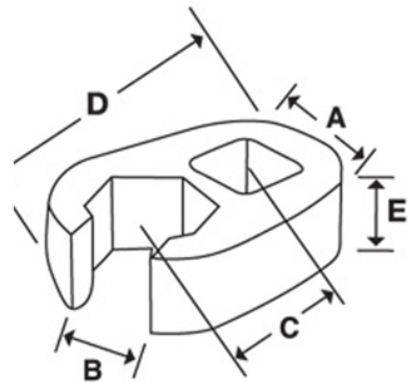
- Featuring a flare nut opening for greater turning power without deforming the fastener



PRODUCT ATTRIBUTES

Product			C	A	E	B	
JHWBCF20	3/8 in	5/8 in	47/64 in	15/16 in	11/16 in	15/32 in	0.09 lb
JHWBCF24	3/8 in	3/4 in	53/64 in	1-1/8 in	23/32 in	9/16 in	0.12 lb