



**BCOM10 - BCOM22**  
**3/8" Drive Crowfoot Wrenches,**  
**Open End, Metric**





**PRODUCT DETAILS**

- Crowfoot wrenches are professional quality, made of high grade steel

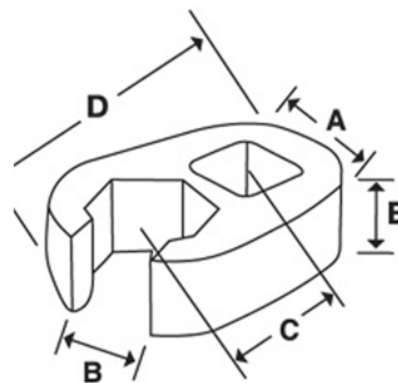
- Featuring an open end with a continuous arc for constant contact with the fastener for greater turning power without deforming the fastener



PRODUCT ATTRIBUTES

Product			<b>A</b>	<b>C</b>	<b>E</b>	<b>F</b>	<b>D</b>	
<b>JHWBCOM10</b>	3/8 in	10 mm	7/8 in	11/16 in	1/4 in	1/2 in	1-1/4 in	0.06 lb
<b>JHWBCOM11</b>	3/8 in	11 mm	7/8 in	5/8 in	1/4 in	1/2 in	1-1/4 in	0.06 lb
<b>JHWBCOM12</b>	3/8 in	12 mm	1 in	13/16 in	1/4 in	1/2 in	1-1/2 in	0.08 lb
<b>JHWBCOM13</b>	3/8 in	13 mm	1 in	6/8 in	1/4 in	1/2 in	1-1/2 in	0.08 lb
<b>JHWBCOM14</b>	3/8 in	14 mm	1 in	6/8 in	1/4 in	1/2 in	1-3/8 in	0.7 lb
<b>JHWBCOM15</b>	3/8 in	15 mm	1-1/4 in	7/8 in	1/4 in	1/2 in	1-5/8 in	0.09 lb
<b>JHWBCOM16</b>	3/8 in	16 mm	1-1/4 in	7/8 in	1/4 in	1/2 in	1-5/8 in	0.08 lb
<b>JHWBCOM17</b>	3/8 in	17 mm	1-1/4 in	13/16 in	1/4 in	1/2 in	1-5/8 in	0.08 lb
<b>JHWBCOM18</b>	3/8 in	18 mm	1-1/2 in	1-1/8 in	1/4 in	1/2 in	1-7/8 in	0.15 lb
<b>JHWBCOM19</b>	3/8 in	19 mm	1-1/2 in	1 in	1/4 in	1/2 in	1-7/8 in	0.14 lb
<b>JHWBCOM20</b>	3/8 in	20 mm	1-1/2 in	1 in	1/4 in	1/2 in	1-7/8 in	0.14 lb
<b>JHWBCOM21</b>	3/8 in	21 mm	1-3/4 in	1-1/8 in	1/4 in	5/8 in	1-7/8 in	0.19 lb
<b>JHWBCOM22</b>	3/8 in	22 mm	1-3/4 in	1 in	1/4 in	5/8 in	2 in	0.19 lb