

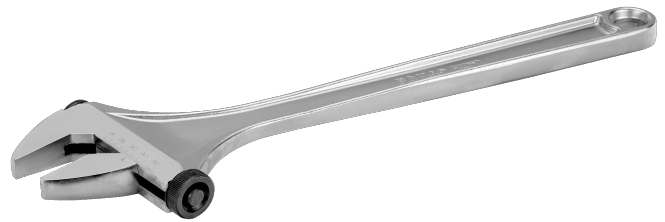

**91C US**  
**Side Nut Adjustable Wrench with**  
**Chrome Finish for Heavy**  
**Applications 155 mm**



**PRODUCT DETAILS**

- Suitable for heavy duty applications
- Smooth movement, heavy-duty performance and precision
- Head angle 15° provides better accessibility
- Laser scale in mm for pre-adjusting and accurate measurement
- Bigger and rounded handles for a comfortable grip
- Chrome plated, precision-hardened and anti-corrosion treated
- High performance alloy steel forged in single piece
- Standards: ISO 6787, DIN 3117, ASME B107.8-2003 and BS 6333
- Exceeding quality standards: ISO +125%, ASME +20%
- Parallel jaws placed at a 15° angle provide a firm grip and best reach
- Comfortable rounded handle
- Smooth movement and precision adjustment with the side nut operating system
- Ultimate strength through precision hardening and high performance alloy steel

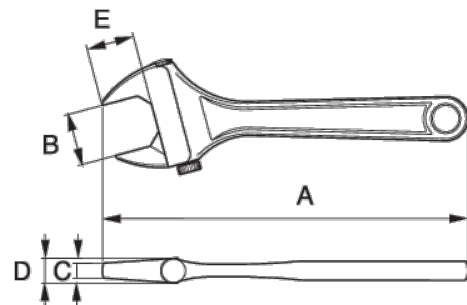

PRODUCT ATTRIBUTES

Product	<b>A</b>	<b>A</b>	<b>B</b>	<b>C</b>	<b>D</b>	<b>E</b>	
<b>91C US</b>	155 mm	6 in	21 mm	6.9 mm	12 mm	18.5 mm	140 g