

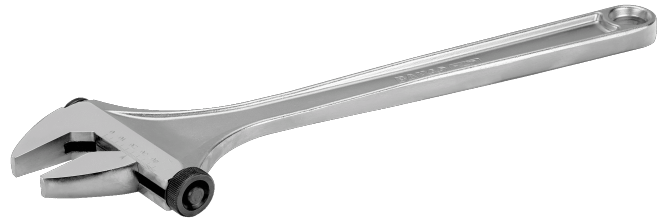

94C US
Side Nut Adjustable Wrench with
Chrome Finish for Heavy
Applications 155 mm



PRODUCT DETAILS

- Suitable for heavy duty applications
- Smooth movement, heavy-duty performance and precision
- Head angle 15° provides better accessibility
- Laser scale in mm for pre-adjusting and accurate measurement
- Bigger and rounded handles for a comfortable grip
- Chrome plated, precision-hardened and anti-corrosion treated
- High performance alloy steel forged in single piece
- Standards: ISO 6787, DIN 3117, ASME B107.8-2003 and BS 6333
- Exceeding quality standards: ISO +125%, ASME +20%
- Parallel jaws placed at a 15° angle provide a firm grip and best reach
- Comfortable rounded handle
- Smooth movement and precision adjustment with the side nut operating system
- Ultimate strength through precision hardening and high performance alloy steel

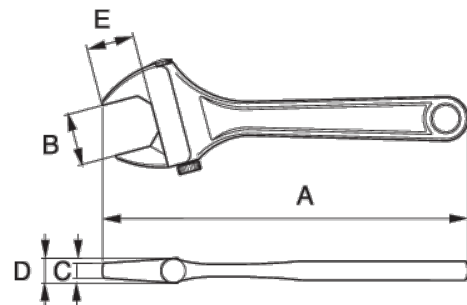

PRODUCT ATTRIBUTES

Product	A	A	B	C	D	E	
94C US	305 mm	12 in	39 mm	13.6 mm	20 mm	36 mm	795 g